

ACHBERG® pipe systems



Detailed information can be found at www.achberg.com/en/products/pipe-systems or scan the QR code:



Pipes

Stainless steel

→ Ø 38 x 1.5 mm – Ø 154 x 2.0 mm

Hardened stainless steel

→ Ø 40 x 1.5 mm – Ø 76.1 x 2.0 mm

Aluminium

→ Ø 38 x 1.5 mm – Ø 219 x 4.0 mm

Glass

→ Ø 47 x 5.0 mm – Ø 80 x 5.0 mm



Bends

Stainless steel

→ Ø 38 x 1.5 mm – Ø 129 mm x 2.0

Hardened stainless steel

→ Ø 38 x 1.5 mm – Ø 114.3 x 2.0 mm

Glass

→ Ø 47 x 5.0 – Ø 80 x 5.0 mm



Pipe fittings

Stainless steel

→ Ø 38 x 1.5 mm – Ø 129 x 2.0 mm
→ 30° branch, 45° branch, 60° branch, Y-piece and T-piece

Hardened stainless steel

→ Ø 38 x 1.5 mm – Ø 114.3 x 2.0 mm
→ 30° branch, 45° branch, Y-piece and T-piece

Glass

→ Ø 44.3 x 3.2 – Ø 80 x 5.0 mm
→ 45° branch and T-piece

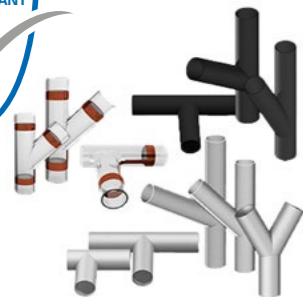

Pipe couplings

Light version

→ Ø 38 mm – Ø 114.3 mm
→ Max. 225 °C
→ Collar made of stainless steel



Medium-/heavy duty

→ Ø 48 mm – Ø 219 mm
→ Max. 225 °C
→ Collar galvanized / made of stainless steel



Tension relief

→ for pipe couplings length 150 / 200 mm
→ Pipe clamps made of stainless steel
→ Connection bars made of aluminium



Hoses

Hose „SCH.01“

→ PVC: for low abrasive granules
→ PVC/PUR: for highly abrasive granules and powders



Hose „SCH.02“

→ PUR 1.4 mm: for abrasive granules
→ PUR 2.0 mm: for heavily abrasive granules



Hose „SCH.03“

→ PVC: for low abrasive granules
→ PVC/PUR: for highly abrasive granules



Suction probes

→ Made of stainless steel
→ Single-walled and double-walled
→ with suction air adjustment or filter



Suction tubes with hinged cover

→ Made of stainless steel
→ With screw-on counter plate and screws
→ Øi 57 mm, Øi 84 mm und Øi 104 mm

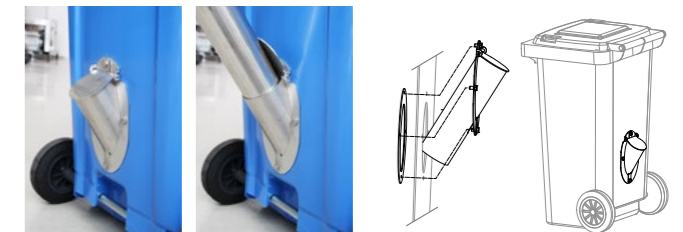

Reducers

Stainless steel

→ Ø 38 mm – Ø 108 mm

Hardened stainless steel

→ Ø 38 mm – Ø 60.3 mm



Threaded pipes

Threaded pipes are used to connect fittings or on blowers.

→ 1.5" bis 4"
→ Made of stainless steel
→ Pipe inside offset-free



Clamps

→ Pipe holding clamp
→ U-clamp



ACHBERG® pipe systems



Detailed information can be found at www.achberg.com/en/products/pipe-systems or scan the QR code:



Couplings

Flexible hose pipes must be reliably connected to pipelines. For this we offer three coupling systems that have become established as reliable technology in the bulk goods industry.

TWIST und TWIST codiert „RFID“

- For pipe Ø 40 mm – Ø 76.1 mm
- Product-carrying parts made of stainless steel
- One-hand operation (1/8 turn when opening)
- Low effort required
- Without internal offset
- Can be retrofitted on existing coupling tables
- Durable construction for rough operating environments



RFID-Technology

- single upgradeability of RFID sensor technology



Protective cover

- Made of stainless steel

Camlock

- Ø 40 mm – Ø 76.1 mm
- Product-carrying parts made of stainless steel



Storz

- Size 2", 2½", 3" and 4" bzw. C, B and A



Coupling table

Couplings



Colour coding

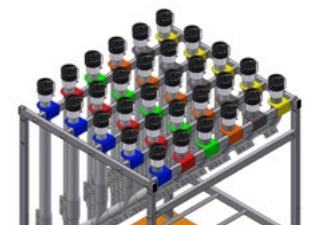

Basic - 4 outlets

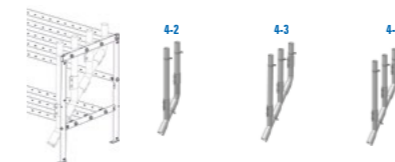

Basic - 5 outlets

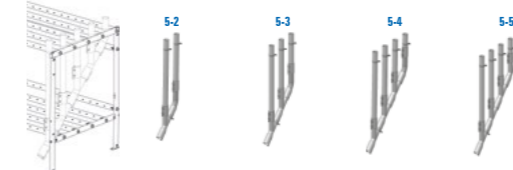

Basic - 6 outlets

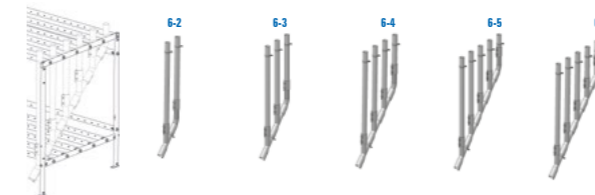

Multi - 4 outlets



Multi - 5 outlets

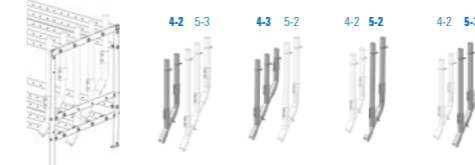

Multi - 6 outlets

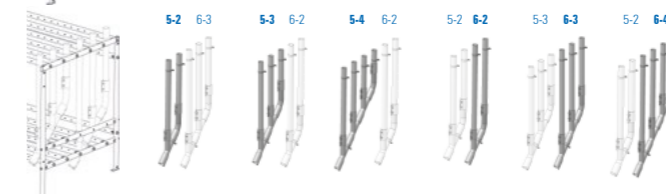

Inlet bends



ACHBERG® pipe systems



Detailed information can be found at www.achberg.com/en/products/pipe-systems or scan the QR code:



Pipe systems for permanent central vacuum systems

Unlike traditional central vacuum systems, several vacuum hopper loaders can be supplied with vacuum at the same time when using a permanent central vacuum system. This enables higher material throughputs and energy cost reductions while increasing system and process stability at the same time.



T-piece 1-way

- For pipe Ø 100 mm – Ø 200 mm
- Connection Ø 50 mm – Ø 100 mm

T-piece 2-way

- For pipe Ø 100 mm – Ø 200 mm
- Connection Ø 50 mm – Ø 60 mm

T-piece 4-way

- For pipe Ø 100 mm – Ø 200 mm
- Connection Ø 50 mm – Ø 60 mm

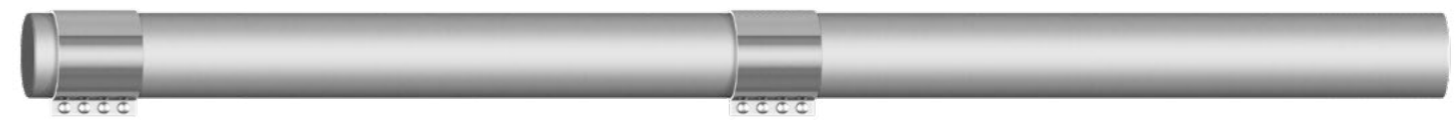

Locking cap

- Stainless steel: Ø 50 mm – Ø 76.1 mm
- Aluminium: Ø 100 mm – Ø 200 mm

Pipe couplings

- For pipe Ø 100 mm – Ø 200 mm

Pipeline

- For pipe Ø 100 mm – Ø 200 mm

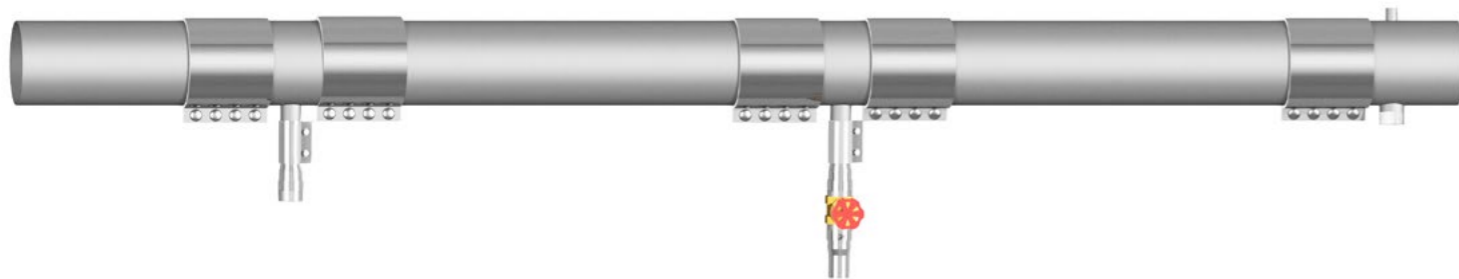

Threaded pipes

- Connection Ø 50 mm – Ø 60 mm
- Length 140 mm

Regulating pipe

- Connection Ø 50 mm – Ø 60 mm
- Length 315 mm

Process pipe

- For pipe Ø 150 mm – Ø 200 mm

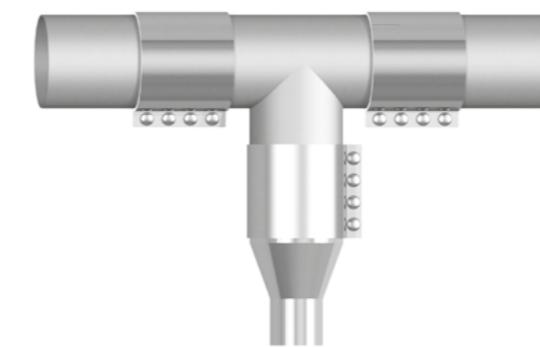

Blower connection

- For pipe Ø 150 mm – Ø 200 mm
- Connection Ø 88.9 mm – Ø 150 mm

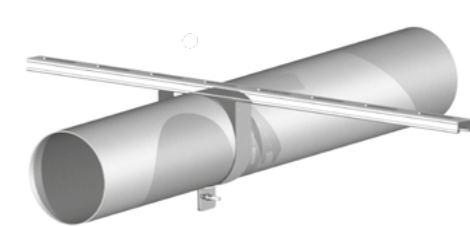

U-clamp

- For pipe Ø 100 mm – Ø 200 mm

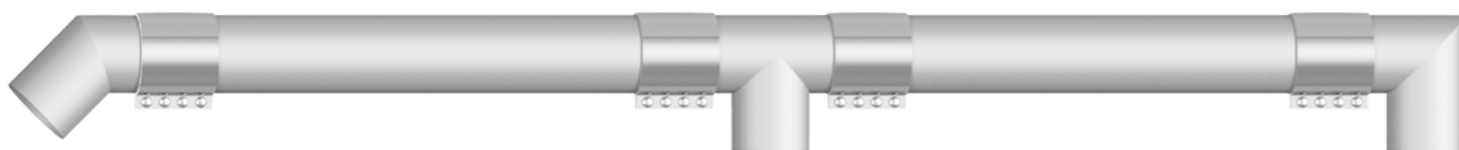

Angle section 45°

- For pipe Ø 100 mm – Ø 200 mm

T-piece

- For pipe Ø 100 mm – Ø 200 mm

L-piece

- For pipe Ø 100 mm – Ø 200 mm